

LAVA

REMOTE CONTROLLED HDTV ANTENNA

Connection Diagram

HD-2805

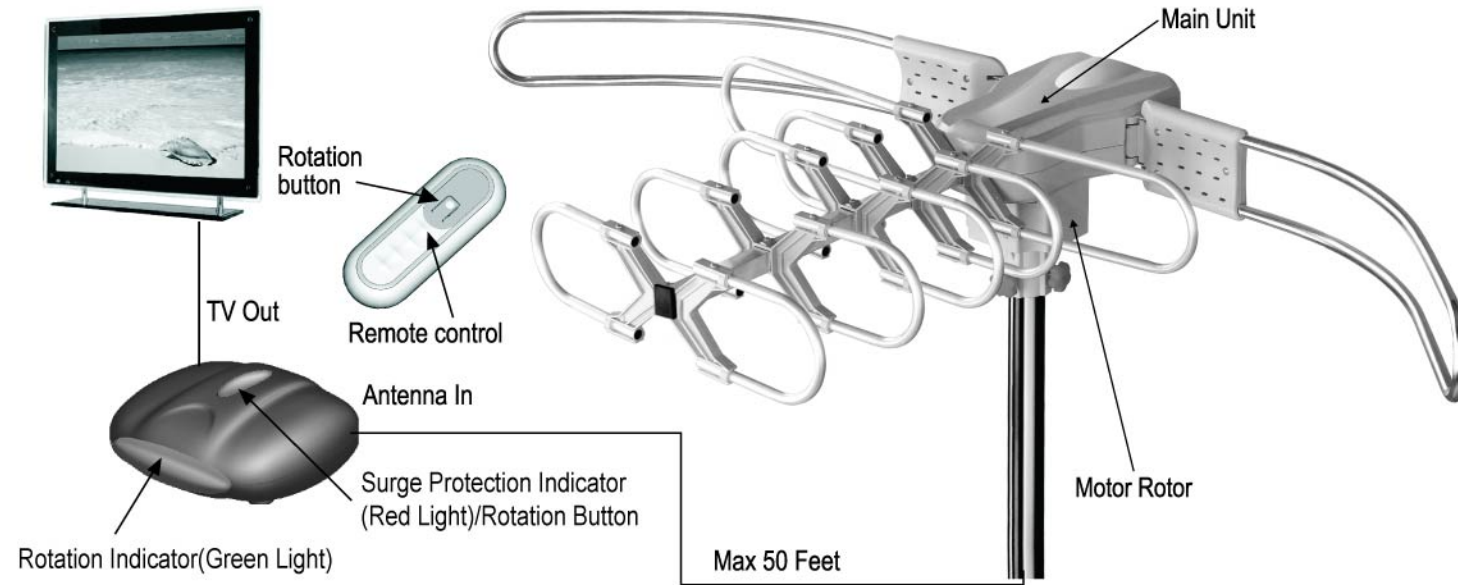

Converter Box Connection

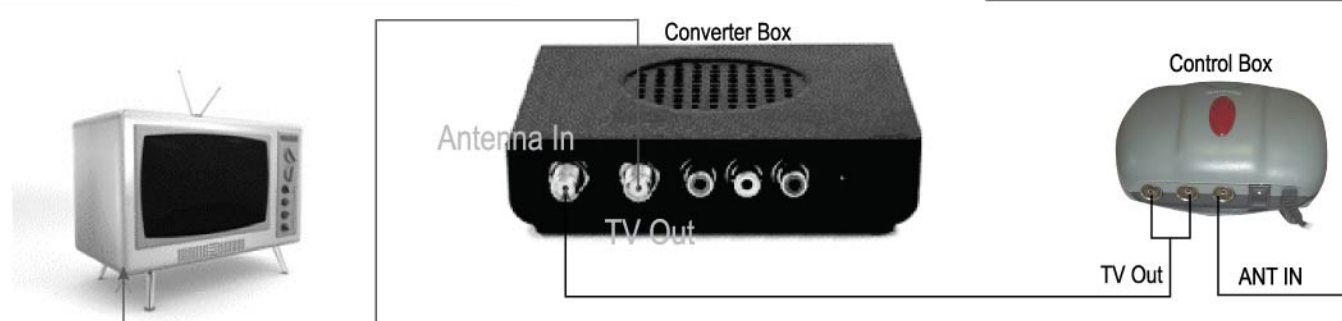

SPECIFICATION

FREQUENCY & ACTUAL GAIN

UHF:470~860MHz 30±3dB
VHF:40~260MHz 25±3dB

NOISE FIGURE: ≤3dB
WORKING VOLTAGE:AC 15-19V

USER INSTRUCTIONS

1. Assemble the antenna as desired in diagrams 1 to 4.
2. Use 1" steel or aluminum pipe to install the antenna. For best reception, install the antenna at the highest point of your roof or at a space that has clear open view.
3. Connect the Antenna using the included RG6 cable to the control box ANT IN port. The control signal will go through the cable to rotate the antenna.
4. Connect the control box TV OUT to your TV RF input (Or connect to your converter box Antenna port).
5. Connect the power adapter to the control box.
6. Scan Channels from your TV menu.

Test the rotation function inside the house before you install the Antenna outside. If the Antenna does not rotate, check the LED light on the Main Unit, the LED light should be always ON if the connection is good and power on the control box is ON.

The Antenna will rotate 360° and then reverse automatically. You can reverse the rotation instantly by double clicking the rotation button twice very quickly.

When there is overload in the control box, the surge protector will function automatically and the surge protection indicator will stay ON. Check the connection for the outage, then reset the power switch.

DO NOT use splitter before the Control Box, you need to make the cable directly from the Main Unit to the Control Box. Use a F-F type coupler if you need to connect two cables together.

Packing List

NO.	Name	Specification	Qty	Image
1	Main Unit		1	
2	Motor Rotor		1	
3	Screw	M4x12mm	4	
4	Screw	M4x10mm	4	
5	3 Feet RG6 Cable		1	
6	Control Box		1	
7	Remote Control		1	
8	Power Adapter		1	
9	Main pole column		1	

INSTALLATION GUIDE

1. Attach the main pole column on the motor rotor using 4 M4x10 screws.

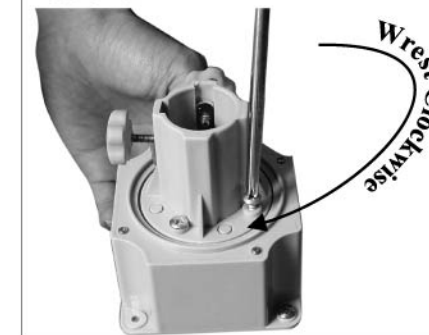

2. Install the Motor Rotor to the main unit using 4pcs M4x12 screws.

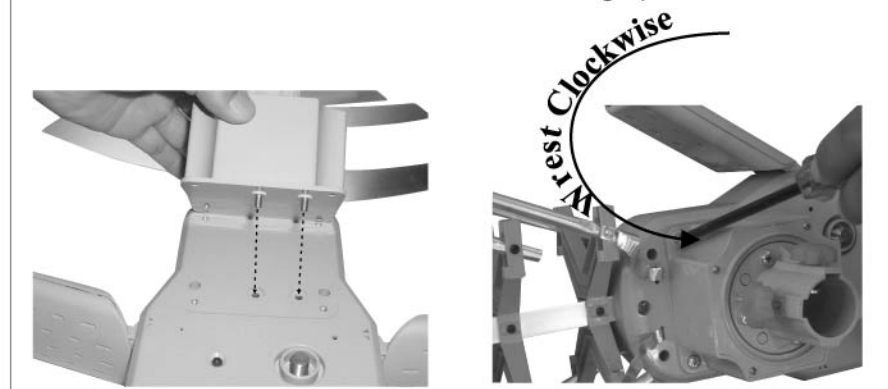

3. Attach the motor rotor on the main unit using 4 M4x12 screws.



4. Connect the RG6 cable to the F connector on the main unit, and screw the main unit on the antenna pole.

